



Environmental Delineations
Tradition, Integrity, Quality, Dependability

213 N. Franklin Street, Dublin, GA 31021
PHONE 478-272-6032 WWW.ENVIRONMENTALDELINEATIONS.COM

COUNTY:	COLUMBIA	DATE:	3/21/2024
OWNER:	PERFORMED FOR COLIN SPALDING		
SITE LOCATION:	RIDGE ROAD		
SCALE:	1 INCH = 60 FEET		
INTENSITY LEVEL OF INVESTIGATION:	LEVEL THREE; DPH STANDARDS		

SOIL SERIES <i>SEE SUITABILITY CODES</i>	SLOPE % <i>ranges of the soil type</i>	DEPTH TO BEDROCK <i>(ranges)</i>	DEPTH TO SEASONAL HIGH "PERCHED" H2O TABLE and/or *RESTRICTIVE <i>(inches/ranges)</i>	ABSORPTION RATE AT RECOMMENDED TRENCH DEPTH <i>(predicted ranges)</i>	RECOMMENDED TRENCH BOTTOM DEPTH <i>(inches)</i>	SUITABILITY CODE
GEORVILLE	1 0-20%	>60"	60"	65	24 TO 36"	A
GROVER	1 0-20%	>60"	60"	65	24 TO 36"	A
SANTUC	0-5%	>60"	24"	SEE CODES	SEE CODES	F
STARR	2-10%	>60"	42 TO 48"	50	18"	U2

AREAS WHICH FLOOD OR HAVE POTENTIAL FOR PROBLEMS ASSOCIATED WITH FLOODING/PONDING SHOULD NOT BE UTILIZED.
AREAS UTILIZED FOR ABSORPTION FIELDS SHOULD BE SHAPED FOR RAPID RUNOFF.

SOIL MAP LEGEND

SOB	SOIL BORING LOCATION
DM	DRAINAGE WAY; UNSUITABLE FOR WASTE DISPOSAL
OTPF	OPEN TOP PIPE FOUND
IFP	IRON PIN FOUND
DBR	DISCONTINUOUS BROKEN ROCK WITH VARIABLE HARDNESS

SOIL SUITABILITY CODES

A	SUITABILITY CODE = SOIL TYPE SHOULD HAVE ABILITY TO FUNCTION AS SUITABLE ABSORPTION FIELD WITH PROPER DESIGN, INSTALLATION, AND MAINTENANCE.
F	SUITABILITY CODE = UNSATISFACTORY FOR USE FOR ABSORPTION FIELDS.
U2	SUITABILITY CODE = THESE SOIL SERIES HAVE THE ABILITY TO FUNCTION AS SUITABLE ABSORPTION FIELDS. HOWEVER, BRIEF PERCHING OF WATER CAN CAUSE TEMPORARY PROBLEMS FOR ABSORPTION FIELDS DURING WET/RAINY PERIODS. THIS PERCHING CAN RESULT IN SHORT PERIODS OF SATURATED SOILS THAT CAN IMPEDIE ON-SITE SYSTEM FUNCTION. GOOD CONTROL OF SURFACE DRAINAGE COMBINED WITH VERY SHALLOW SYSTEM INSTALLATION ALONG WITH SITE WATER MANAGEMENT CAN HELP OFFSET PROBLEMS ASSOCIATED WITH THE LAYER WHICH CAUSES THE PERCHING. MAINTAIN 2 FEET SEPARATION OFF SEASONAL HIGH/PERCHED WATER TABLE.

GENERAL NOTES FOR THIS SITE

- MAKE SURE THE PROPOSED SEPTIC AREAS ARE PROTECTED DURING THE CONSTRUCTION PROCESS AND ARE NOT ALLOWED TO BECOME STORAGE AREAS FOR FILL DIRT, OR USED FOR TRASH PITS. ALSO, KEEP HEAVY EQUIPMENT FROM PARKING AND DRIVING ON THE SEPTIC AREA WHICH COULD CAUSE COMPACTION OF THE SOIL. SHAPE DRAIN FIELD FOR RAPID RUN OFF. MUST CONTROL SURFACE WATER FROM ANY LAND AREA LOCATED UP GRADIENT.
- THE ABSORPTION FIELD SHOULD NOT BE INSTALLED DURING A WET OR RAINY PERIOD WHICH COULD RESULT IN DAMAGE TO THE SOIL STRUCTURE AND RESULT IN REDUCED SYSTEM PERFORMANCE.

The information contained in this report is based on the pedons (test borings) classified in the field. All boring locations, as well as, other miscellaneous soil conditions and features, are located with a Trimble Pro XR5 Global Positioning Satellite System (GPS) to assist in maintaining quality control. If the site is disturbed from cutting or filling after the date of this soil report, the Soil Scientist whose seal is affixed to this report and his recommendations are null and void. The projected boundary of each soil map unit is based on the professional opinion and judgment of the Soil Scientist. Soil boundary lines should be considered as transitional zones where one soil condition intergrades into another, rather than, as an exact boundary. ED,LLC does not install, maintain or permit waste disposal systems and does not guarantee the performance of any waste disposal system.

Full length systems using three foot wide trenches with equal lengths of line and equal distribution (e.g. distribution box) installed on the contour of the landscape will increase longevity and long term performance and is recommended for all systems. Your local Health Department holds full authority in the permitting of onsite waste disposal systems. The use of advanced treatment (e.g. Aerobic Treatment Systems) to decrease the standard 24" inch separation off a seasonal high water table or restrictive layer does not guarantee the proper function of a septic system. A number of systems will meet "code", but that does not necessarily mean that all systems that meet "code" will function properly. Recommendations are site specific and if not followed will void this report. This report is based on conventional septic systems and all recommendations are based on installation from the original unaltered soil surface unless stated otherwise. ED,LLC produces soils surveys based on the USDA Soil Survey Manual, U.S. Soil Taxonomy, and all mapping is completed in accordance with the National Cooperative Soil Survey Standards. Any changes or alterations made to the soil maps or interpretations without the written approval of ED,LLC voids the seal of the Soil Scientist. This report reflects the soil conditions as they relate to on-site waste disposal and shall not be used to determine suitability of lot/ers and/or building foundations. The information herein is intended for the sole use of the client named above. Use by any other party must be with the express written permission by ED,LLC and risk for purposes other than those expressly indicated by this report is at the risk of the user. The lot boundary shown was taken from the county Tax Assessor's public record maps and was electronically traced and used as the background image in completing this soil survey and is for illustration purposes only and shall be considered approximate. The soil borings were located with a GPS and are correctly located in relation to each other. ED,LLC does not guarantee the accuracy of the information provided by others.

HOME SITE
DESIGNATED BY CLIENT

Soil Mapping *Wetland Delineations* GPS Data Collection
Environmental Delineations, LLC
Tradition, Integrity, Quality, Dependability®
770-227-2999 • 478-272-6032
www.environmentaldelineations.com

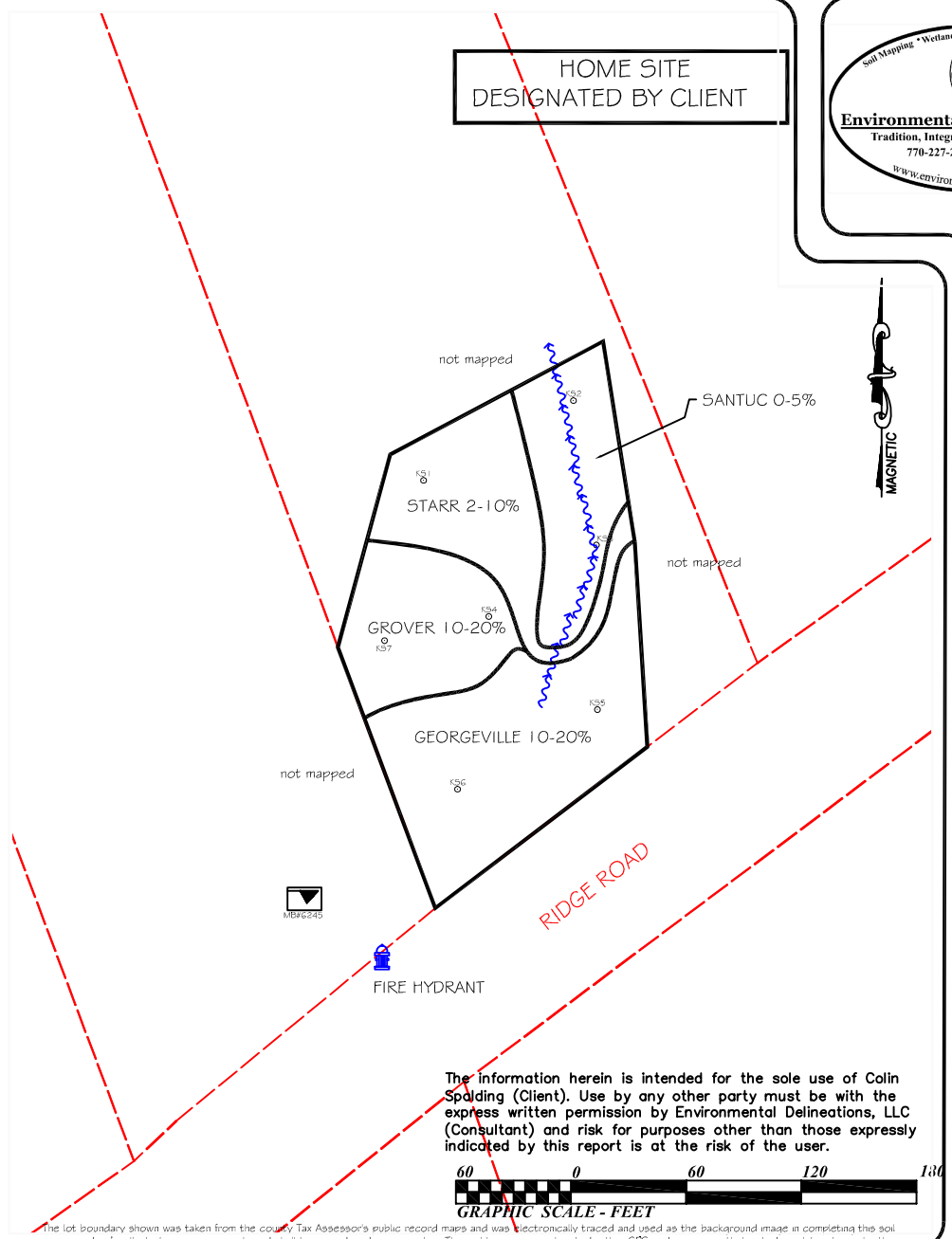

JOB TITLE:
LEVEL THREE SOIL SURVEY
RIDGE ROAD - COLUMBIA COUNTY

DATE:	3-21-2024
CLIENT:	CSPALDING
DRAWN BY:	KLS
SITE WORK:	KLS
CHECKED BY:	KLS



THIS DRAWING IS THE PROPERTY OF ENVIRONMENTAL DELINEATIONS, LLC. THIS DRAWING MAY NOT BE REPRODUCED WITHOUT EXPRESS WRITTEN CONSENT. ANY CHANGES OR PLANS OF THE SITE AFTER THE DATE OF THIS SOIL MAP VOID THE INFORMATION HEREON. ED,LLC DOES NOT DESIGN, PERMIT OR INSTALL ANY SITE WASTE DISPOSAL SYSTEM AND DOES NOT GUARANTEE THE FUNCTION OF ANY ON-SITE WASTE DISPOSAL SYSTEM. YOUR HEALTH DEPARTMENT MAY VIEW THE SOIL CONDITIONS PRESENTED BY THE SOIL SCIENTIST AND WILL HAVE THE FINAL SAY IN THAT COUNTRY. IT IS ESSENTIAL TO MAINTAIN YOUR SEPTIC SYSTEM TO PROMOTE LONGEVITY.

The information herein is intended for the sole use of Colin Spalding (Client). Use by any other party must be with the express written permission by Environmental Delineations, LLC (Consultant) and risk for purposes other than those expressly indicated by this report is at the risk of the user.

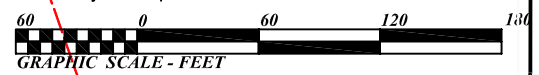

The lot boundary shown was taken from the county Tax Assessor's public record maps and was electronically traced and used as the background image in completing this soil survey and is for illustration purposes only and shall be considered approximate. The soil borings were located with a GPS and are correctly located in relation to each other.

KEVIN L. SMITH
SOIL SCIENTIST #187