

REGISTERED LAND SURVEYOR'S INSPECTION
 PLAT AND CERTIFICATE FOR MORTGAGE
 LOAN PURPOSE

J.O. NO.: 20-07-245

Customer: American Eagle Title Group, LLC

Borrower: M&M Capital Investments LLC
 2008-0034-17

Plat No: 3262

COLLINS LAND SURVEYING, INC.
 3340 W. 151st ST. S. - P.O. Box 250
 KIEFER, OK. 74041

OFFICE (918)321-9400 FAX (918)321-9404

B/L=Building Line U/E=Utility Esmt. F/E=Fence Esmt.	OB/L=Out Building Line SW/E=Sidewalk Esmt. R/W=Right of Way	D/E=Drainage Esmt. B/E=Buried Tele. & Elec. Cable Esmt. S/E=Service Entrance	SCALE: 1"=50'	↑ NORTH
-----------------------------------------------------------	-------------------------------------------------------------------	------------------------------------------------------------------------------------	---------------	---------

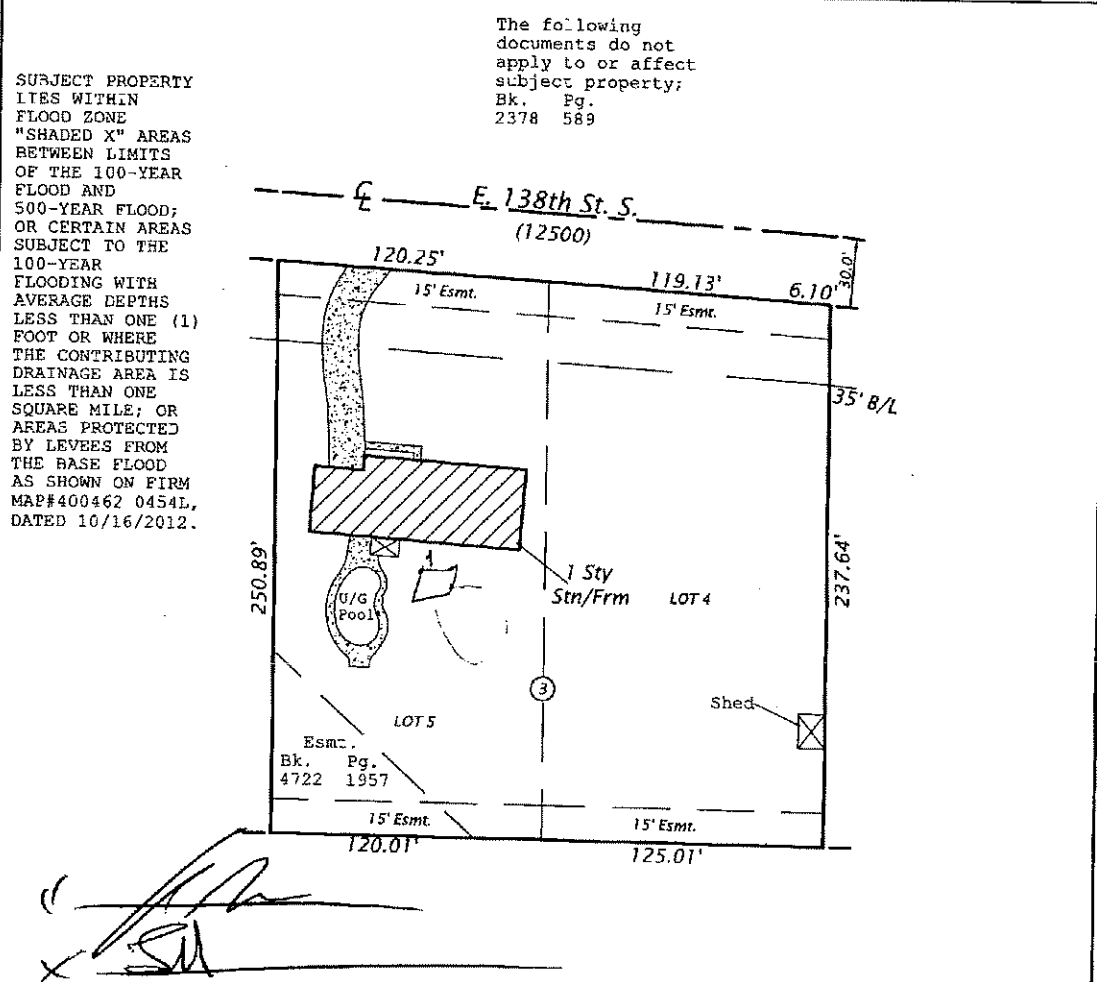

THIS PLAT IS MADE FOR AND AT THE REQUEST OF:
 American Eagle Title Group, LLC / First Oklahoma Bank
 FOR MORTGAGE LOAN PURPOSES ONLY COVERING LEGAL DESCRIPTION AS PROVIDED

Lots Four (4) and Five (5), Block Three (3), HICKORY HILLS 4TH ADDITION, an Addition in Tulsa County, State of Oklahoma, according to the recorded Plat No. 3262.

Property address: 12500 East 138th Street South, Broken Arrow, Oklahoma

SURVEYORS STATEMENT

COLLINS LAND SURVEYING INC., AN OKLAHOMA CORPORATION, AND THE UNDERSIGNED REGISTERED PROFESSIONAL LAND SURVEYOR DO HEREBY STATE THAT IN OUR PROFESSIONAL OPINION, THE ABOVE INSPECTION PLAT SHOWS THE DWELLING AS LOCATED ON THE PREMISES DESCRIBED, THAT IT IS ENTIRELY WITHIN THE DESCRIBED TRACT BOUNDARIES AND THERE ARE NO ENCROACHMENTS THEREON BY VISIBLE PERMANENT IMPROVEMENTS, EXCEPT AS INDICATED; THAT THE ABOVE INSPECTION PLAT SHOWS ALL RECORDED PLAT EASEMENTS AND OTHER SUCH EASEMENTS WHICH HAVE BEEN DISCLOSED BY A CURRENT TITLE OPINION OR BY COMMITMENT FOR TITLE INSURANCE AND COPIES THEREOF PROVIDED TO US; THAT THIS INSPECTION PLAT WAS PREPARED FOR IDENTIFICATION ONLY FOR THE MORTGAGE AND IS NOT A LAND OR BOUNDARY LINE SURVEY, THAT NO PROPERTY CORNERS WERE SET, AND IS NOT TO BE USED OR RELIED UPON FOR THE ESTABLISHMENT OF FENCE, BUILDING, OR OTHER IMPROVEMENTS, THAT UNDERGROUND UTILITIES WERE NOT FIELD LOCATED AND THEREFORE ARE NOT SHOWN ON THIS INSPECTION PLAT UNLESS SPECIFICALLY REQUESTED BY THE CLIENT; THAT THIS INSPECTION PLAT WAS PREPARED SOLELY FOR THE CLIENT LISTED HEREON AND MAY NOT BE USED FOR ANY SUBSEQUENT LOAN CLOSING, REPINANCE, OR OTHER TRANSACTION; AND THAT NO RESPONSIBILITY OR LIABILITIES ASSUMED HEREBY TO THE PRESENT OR FUTURE LAND OWNER OR OCCUPANT. BURIED SERVICE CABLE LOCATIONS ARE APPROXIMATE; CALL ONE BEFORE DIGGING 1-(800)-622-6543

WITNESS MY HAND AND SEAL THIS DATE:
 FINAL; 08/20/2020



K.S. Collins
 K.S. COLLINS
 OKLAHOMA REGISTERED
 LAND SURVEYOR NO. 1259
 CA#2656 EXPIRES: 06/30/2022

